

DOCUMENT CHANGES

Description	Date

Issue Description	CONSTRUCTION DOCUMENTS
Original Issue Date	06/24/2024
Project No	23179.00
Drawn By	HCC
Checked By	HCC
Drawing Title	

**1ST FLOOR
DEMOLITION PLAN,
NOTED PLAN &
REFLECTED CEILING PLAN**

WALL FRAMING & SOUND RATING LEGEND	
ALL INTERIOR STUD WALLS AND FURRUTS TO BE CONSTRUCTED WITH 3 5/8" METAL STUD FRAMING UNLESS DENOTED WITH TAGS BELOW.	
(1)	5/8" GYP. BD. ON 7/8" METAL FURRING OVER CONCRETE OR CMU SUBSTRATE
(2)	1 5/8" GYP. BD. ON 7/8" METAL FURRING OVER CONCRETE OR CMU SUBSTRATE
(3)	2 1/2" METAL STUDS
(4)	6" METAL STUDS
(5)	8" CMU
(6)	12" CMU
DIMENSIONED NOTE: FOR EASE OF PARTITION LAYOUT, ALL STANDARD DRYWALL PARTITIONS ARE DIMENSIONED TO THE FACE OF THE STUD UNLESS OTHERWISE NOTED. CHASES, SHAFTWALL AND CMU WALLS ARE DIMENSIONED FROM FINISHED FACE OF GYPSUM BOARD TO FINISHED FACE OF GYPSUM BOARD. EXISTING WALLS ARE DIMENSIONED TO THE EXISTING FINISHED FACE.	
*OR EQUIVALENT TESTED ASSEMBLY AS APPROVED BY ARCHITECT	
STC	DESCRIPTION
(A)	STC 40 BASIS OF DESIGN - NGC 2016074* (NON-RATED & 1 HR) 3 5/8" STUD - 20 GA. (33 MIL) 16" O.C. - 3 1/2" GLASS FIBER INSULATION (1 LAYER OF 5/8" TYPE X GYPSUM BD. ON EACH SIDE)
(B)	STC 46 BASIS OF DESIGN - NGC 2018106* (NON-RATED & 1 HR) 3 5/8" STUD - 20 GA. (33 MIL) 16" O.C. - 3 1/2" GLASS FIBER INSULATION (1 LAYER OF 5/8" TYPE X GYPSUM BD. ON EACH SIDE)
(C)	STC 48 BASIS OF DESIGN - NCMA TEK 13-01C 6" HOLLOW UNIT CMU WALL - NORMAL WEIGHT 125 PCF
(D)	STC 49 BASIS OF DESIGN - NGC 2016082* (NON-RATED, 1 HR. & 2 HR) 3 5/8" STUD - 20 GA. (33 MIL) 16" O.C. - 3 1/2" GLASS FIBER INSULATION (2 LAYERS OF 5/8" TYPE X GYPSUM BD. ON EACH SIDE)
(E)	STC 51 BASIS OF DESIGN - NGC 2019013* (2 HR SHAFTWALL) 6" MIN. C-T STUDS - 20 GA. (33 MIL) 24" O.C. - 5" GLASS FIBER INSULATION (2 LAYERS OF 5/8" TYPE X GYPSUM BD. ON ONE SIDE - 1 LAYER OF TYPE X 1" SHAFTLINER CORE ON THE OTHER)
(F)	STC 52 BASIS OF DESIGN - NGC 2018113* (NON-RATED & 2 HR) 3 5/8" STUDS - 20 GA. (33 MIL) 16" O.C. - 3 1/2" GLASS FIBER INSULATION (2 LAYERS OF 5/8" TYPE X GYPSUM BD. ON EACH SIDE)
(G)	STC 52 BASIS OF DESIGN - NCMA TEK 13-01C 12" HOLLOW UNIT CMU WALL - NORMAL WEIGHT 125 PCF
(H)	STC 53 BASIS OF DESIGN - NGC 2019014* (1 HR SHAFTWALL) 6" C-T STUDS - 20 GA. (33 MIL) 24" O.C. - 5" GLASS FIBER INSULATION (1 LAYER OF 5/8" TYPE X GYPSUM BD. ON ONE SIDE - 1 LAYER OF 1" TYPE X SHAFTLINER CORE ON THE OTHER SIDE)
(I)	STC 57 BASIS OF DESIGN - NCMA TEK 13-01C 6" GROUT FILLED CMU WALL - NORMAL WEIGHT 125 PCF
(J)	STC 57 BASIS OF DESIGN - NGC 2013027* (NON-RATED & 1 HR) 6" STUDS - 20 GA. (33 MIL) 16" O.C. - 6" GLASS FIBER INSULATION (1 LAYER OF 5/8" TYPE X GYPSUM BD. ON ONE SIDE AND 1 LAYER OF 5/8" SOUNDBREAK XP GYPSUM BD. ON THE OTHER SIDE)
(K)	STC 60 BASIS OF DESIGN - NGC 2019085* (NON-RATED & 1 HR) DOUBLE ROW 3 5/8" STUDS - 20 GA. (33 MIL) 16" O.C. - BRACED WITH SPACER BAR - 3 1/2" GLASS FIBER INSULATION (1 LAYER OF 5/8" TYPE X GYPSUM BD. ON EACH SIDE)
(L)	STC 62 BASIS OF DESIGN - NGC 2019085* (NON-RATED, 1 HR. & 2 HR) 6" STUDS - 20 GA. (33 MIL) 16" O.C. 6" FORMALDEHYDE FREE MINERAL WOOL INSULATION (2 LAYERS OF 5/8" TYPE X GYPSUM BD. ON ONE SIDE - 1 LAYER OF 5/8" TYPE X GYPSUM BD. AND 1 LAYER OF 5/8" SOUNDBREAK XP GYPSUM BD. ON THE OTHER SIDE)
(M)	STC 63 BASIS OF DESIGN - NCMA TEK 13-01C 12" GROUT FILLED CMU WALL - NORMAL WEIGHT 125 PCF
(N)	STC 63 BASIS OF DESIGN - NGC 2018084* (CHASE WALL, NON-RATED & 1 HR UNBALANCED) STAGGERED DOUBLE ROW OF 3 5/8" STUDS - 20 GA. (33 MIL) 16" O.C. - BRACED WITH SPACER BAR 3 1/2" GLASS FIBER INSULATION ON BOTH SIDES (1 LAYER OF 5/8" TYPE X GYPSUM BOARD ON ONE SIDE AND 2 LAYERS OF TYPE X GYPSUM BD. ON THE OTHER SIDE)
(O)	STC 67 BASIS OF DESIGN - NGC 2019085* (NON-RATED, 1 HR. & 2 HR) STAGGERED DOUBLE ROW OF 3 5/8" STUDS - 20 GA. (33 MIL) 16" O.C. - BRACED WITH SPACER BAR - 3 1/2" GLASS FIBER INSULATION BOTH SIDES (2 LAYERS 5/8" TYPE X GYPSUM BOARD ON EACH SIDE)

NOTES:
1. VERIFY ALL METAL STUD THICKNESS AND SOUND ATTENUATION LEVEL OF EACH WALL WITH ALL OTHER REQUIREMENTS IN THE CONTRACT DOCUMENTS.
2. THE ASSEMBLIES LISTED HERE ARE FOR SOUND RATINGS ONLY. SEE LISTED UL ASSEMBLIES AND CONTRACT DOCUMENTS FOR OTHER SPECIFIC REQUIRED DESIGN CRITERIA FOR WALL ASSEMBLIES

WALL LEGEND	
	EXISTING NON-RATED PARTITION TO 4" ABOVE CEILING
	EXISTING NON-RATED PARTITION TO DECK
	EXISTING SMOKE PARTITION TO DECK
	EXISTING 30-MINUTE FIRE PARTITION
	EXISTING 1-HOUR FIRE BARRIER
	EXISTING 1-HOUR SMOKE BARRIER
	EXISTING 1-HOUR RATED SHAFT WALL BARRIER
	EXISTING 2-HOUR FIRE BARRIER
	EXISTING 2-HOUR SMOKE BARRIER
	EXISTING 2-HOUR RATED SHAFT WALL BARRIER
	EXISTING NON-RATED C.M.U. PARTITION TO DECK
	EXISTING 1-HOUR C.M.U. FIRE BARRIER TO DECK
	EXISTING 2-HOUR C.M.U. FIRE BARRIER TO DECK
	EXISTING 1-HOUR C.M.U. SMOKE BARRIER TO DECK
	EXISTING CAST-IN-PLACE CONC.
	EXISTING 2-HOUR CONC. FIRE BARRIER
	EXISTING 2-HOUR CONC. SMOKE BARRIER
	NON-RATED PARTITION TO 4" ABOVE CEILING
	NON-RATED PARTITION TO DECK
	SMOKE PARTITION TO DECK
	1-HOUR FIRE BARRIER
	1-HOUR SMOKE BARRIER
	2-HOUR FIRE BARRIER
	2-HOUR SMOKE BARRIER
	2-HOUR RATED SHAFT WALL BARRIER

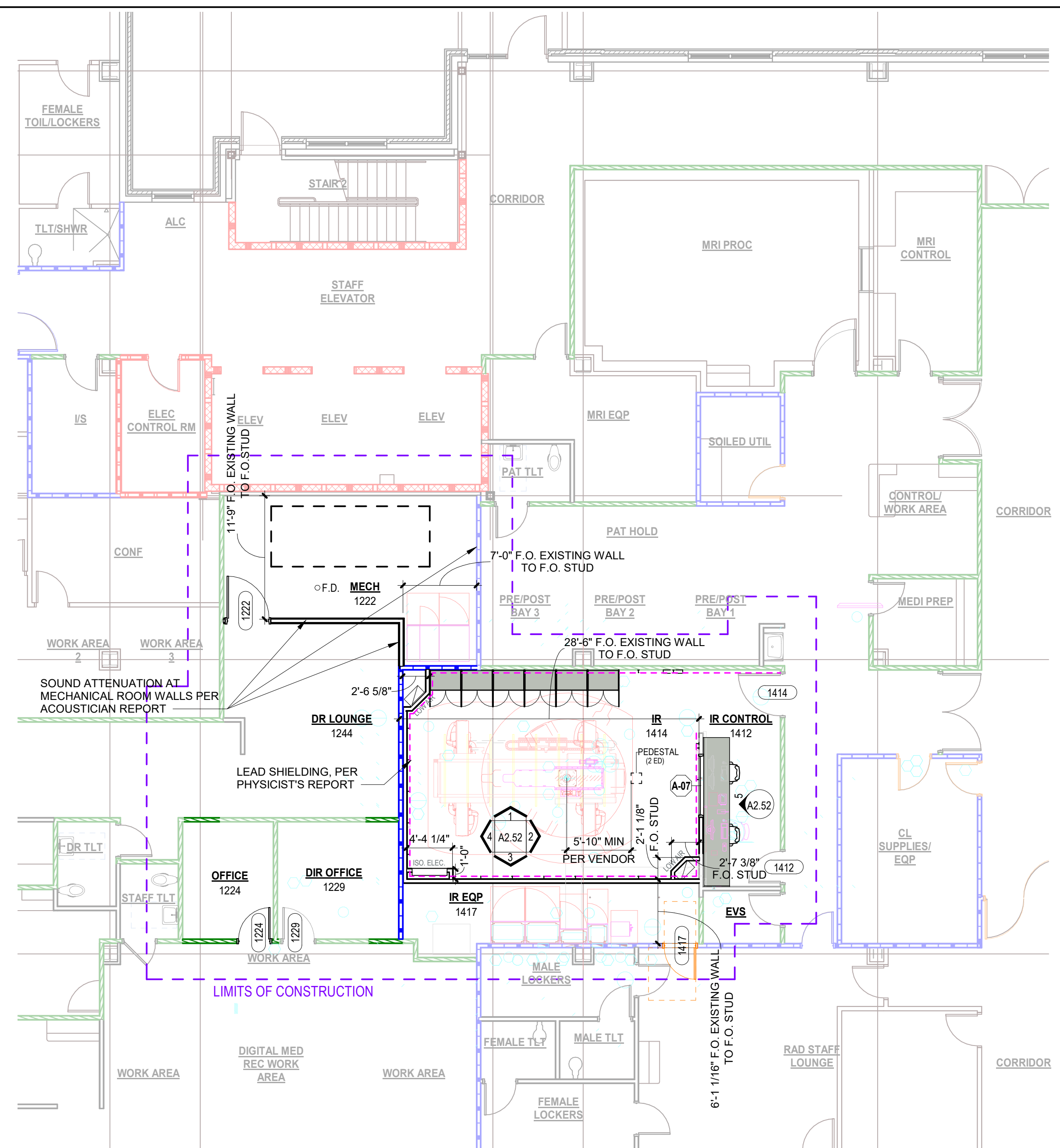

FIRST FLOOR NOTED PLAN
SCALE: 1/8" = 1'-0"

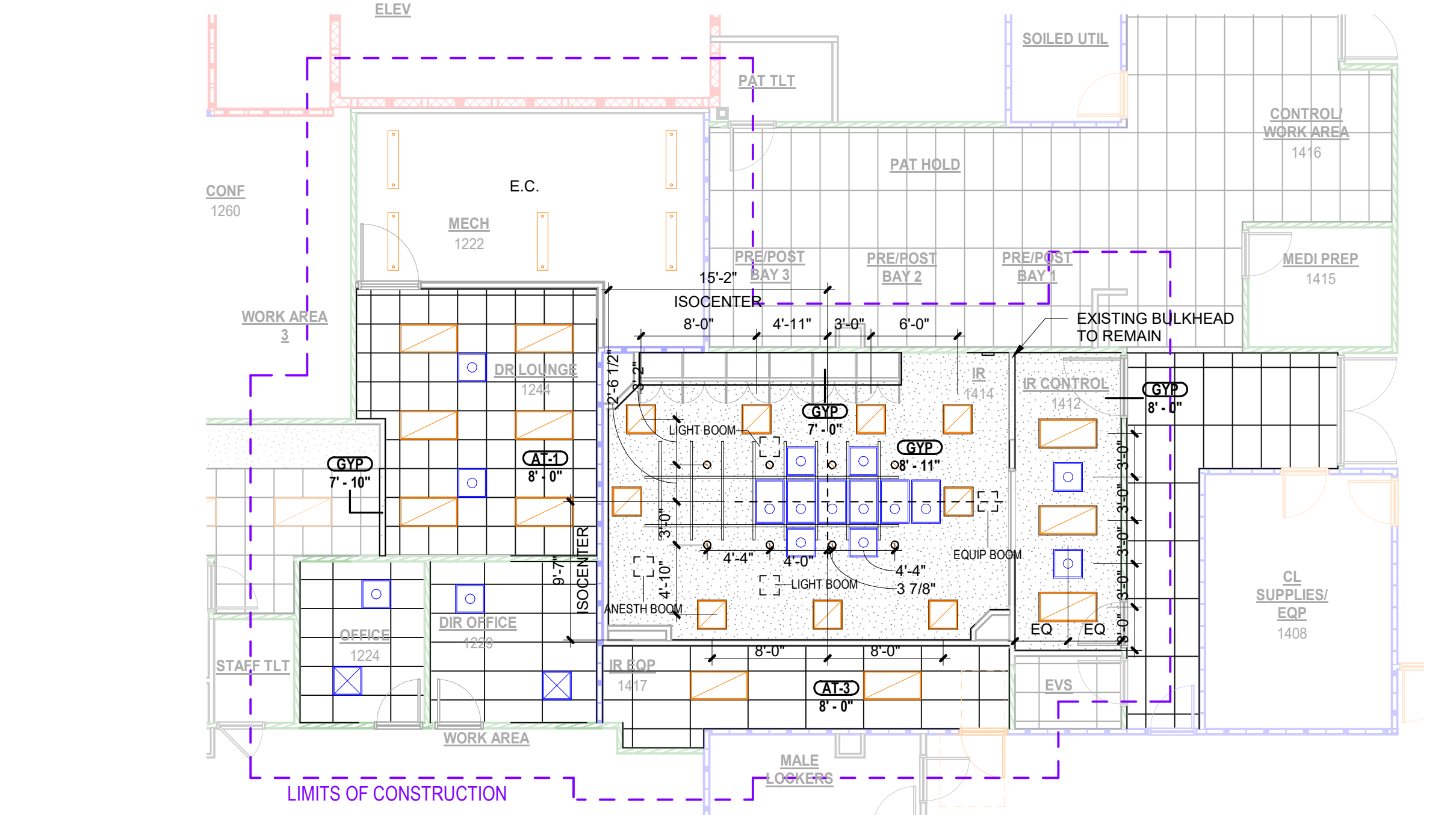

FIRST FLOOR REFLECTED CEILING PLAN
SCALE: 1/8" = 1'-0"

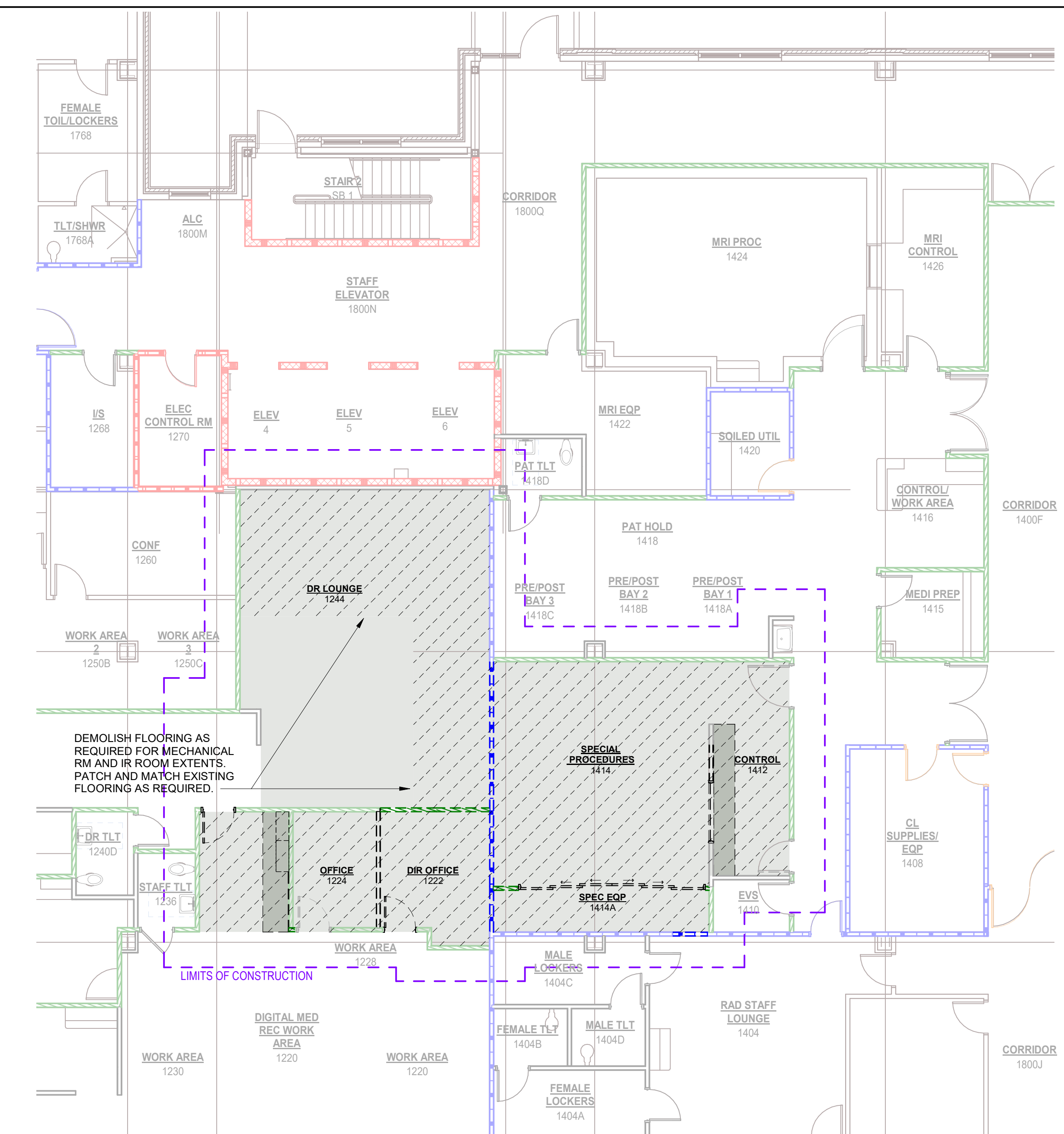

FIRST FLOOR DEMOLITION PLAN
SCALE: 1/8" = 1'-0"

DEMOLITION LEGEND	
	EXISTING WALLS TO BE REMOVED
	EXISTING WALLS TO REMAIN
	REMOVE EXISTING FLOORING AND WALL BASE. SEE FINISH PLANS FOR EXTENT OF NEW WORK. PREPARE SUBSTRATE FOR NEW FINISHES
	CEILING TO BE REMOVED

GENERAL DEMOLITION PLAN NOTES

- DEMOLITION WORK WILL BE GOVERNED BY THE EXTENT OF NEW CONSTRUCTION INVOLVED. CONTRACTOR WILL VERIFY AND COORDINATE DEMOLITION WORK WITH RESPECT TO THE NEW CONSTRUCTION. CONTRACTOR TO VERIFY EXISTING CONDITIONS BEFORE START OF WORK.
- REMOVAL OF EXISTING EQUIPMENT, PIPING, DUCTS, ETC. SHALL INCLUDE ALL ANCHORS, HANGERS, ETC. AFTER REMOVAL, FLOORS, WALLS AND CEILINGS SHALL BE FINISHED TO MATCH ADJOINING SURFACES OR SHALL BE PREPARED TO RECEIVE NEW FINISHES AS INDICATED IN THE NEW FINISH SCHEDULE. MAINTAIN EXISTING FINISHES AS NOTED ON THE NEW FINISH SCHEDULE.
- PATCH AND REPAIR TO MATCH EXISTING CEILINGS, FLOORS, OR WALL FINISHES AFFECTED BY DEMOLITION WORK UNLESS OTHERWISE NOTED ON THE PLANS. NEW WORK TO HAVE SMOOTH AND LEVEL TREATMENT WITH THE EXISTING CONSTRUCTION.
- SPACE NAMES SHOWN ON NEW FLOOR PLANS WITH SPACE NUMBERS NEXT TO THEM ARE TO HAVE NEW WORK DONE IN THEM. COORDINATE WITH THE NEW FINISH SCHEDULE.
- MATCH THICKNESS OF EXISTING WALL AND CEILING FINISH MATERIAL WHERE PATCHING AND REPAIRING IS REQUIRED.
- IT IS THE CONTRACTOR'S RESPONSIBILITY TO NOTIFY THE ARCHITECT AND COORDINATE INSPECTIONS (IF REQUIRED) BY STATE AGENCIES AND MEET ANY APPLICABLE CODE FOR REUSE OF EXISTING PLUMBING FIXTURES, DIFFUSERS AND DUCTWORK.
- RETURN ALL EQUIPMENT, CASEWORK, CABINETS, HARDWARE, ELECTRICAL ITEMS, PLUMBING FIXTURES, ETC. NOT SHOWN AS RELOCATED, TO HOSPITAL MAINTENANCE.
- COORDINATE DEMOLITION PLANS WITH PLANS FOR NEW CONSTRUCTION FOR EXTENT OF REMOVAL. REMOVE ONLY THOSE PORTIONS OF WALLS AND FLOORS NECESSARY TO ACCOMMODATE NEW CONSTRUCTION. TAKE REASONABLE CARE IN REMOVAL OF ITEMS TO BE RELOCATED AND REUSED.
- ALL ABANDONED FLOOR PENETRATIONS SHALL BE PATCHED WITH CONCRETE AND REPAIRED TO MATCH EXISTING CONSTRUCTION AND TO MAINTAIN FLOOR INTEGRITY.
- CONTRACTOR SHALL CHECK ALL EXISTING CORRIDOR WALLS IN THOSE AREAS OF RENOVATION FOR OPENINGS. ANY OPENINGS SHALL BE CLOSED TIGHT AS REQUIRED TO MATCH EXISTING CONSTRUCTION AND TO MAINTAIN FIRE OR EXISTING WALL RATING. THIS IS TYPICAL FOR ALL WORK DONE IN AREAS WHERE RENOVATION IS BEING DONE.
- OPENINGS TO BE CLOSED IN EXISTING FIRE OR SMOKE WALLS SHALL BE PATCHED TO MATCH EXISTING CONSTRUCTION AND TO MAINTAIN THE INTEGRITY OF THE WALL. THIS IS TYPICAL FOR ALL WORK DONE IN AREAS WHERE NEW CONSTRUCTION AND RENOVATION IS BEING DONE.
- ALL WALLS SHOWN BY DASHED LINES ARE TO BE REMOVED COMPLETELY, ALONG WITH DOORS AND FRAMES, ELECTRICAL ITEMS, PLUMBING FIXTURES, CASEWORK, ETC. SEE DEMOLITION PLANS OF MP&E DISCIPLINES AND FINISH PLANS.
- AFTER REMOVAL OF PLUMBING FIXTURES, CAP WASTE LINES BELOW FLOOR SLAB AND SUPPLY LINES ABOVE CEILING.
- ALL WORK SHALL BE SCHEDULED IN A MANNER TO MAINTAIN THE OWNERS CONTINUOUS USE OF THE BUILDING.
- ANY ITEMS REMOVED BY CONTRACTOR FROM WALLS TO HAVE THE REMAINING HOLE PATCHED TO MATCH THE EXISTING CONSTRUCTION.
- CARE SHALL BE TAKEN IN REMOVAL OF REUSED ITEMS THAT CAN BE RELOCATED. RETURN TO OWNER ALL OTHER ITEMS.
- LOCATE TEMPORARY WALLS WITH EXIT SIGNS WHERE REQUIRED. DO NOT BLOCK EXISTING FIRE EXITS. THE CONTRACTOR SHALL CONTACT THE OWNER'S REPRESENTATIVE BEFORE ERECTING TEMPORARY PARTITIONS. FOR COORDINATION OF THESE WALLS - REFER TO THE PLANS FOR LOCATIONS OF TEMPORARY WALLS.
- CONCRETE FLOORS SHALL BE REMOVED FOR INSTALLATION AND CONNECTION OF NEW PLUMBING AND PATCH WITH 3,000 PSI CONCRETE.
- SEE LIMITS OF CONSTRUCTION ON NEW FLOOR PLANS. GENERALLY, ROOMS OUTSIDE OF LIMITS OF CONSTRUCTION ARE NOT TO HAVE ANY WORK DONE IN THEM WITH THE EXCEPTION OF FLOOR OR CEILING TO BE PATCHED OR REPAIRED FOR INSTALLATION OF NEW WORK. CONTRACTOR SHALL USE EXISTING FLOOR OR CEILING MATERIAL FOR REPAIR, SALVAGED FROM AREAS WHERE EXISTING MATERIALS ARE REMOVED OR ALL NEW MATERIAL IN A ROOM IF NECESSARY THAT MATCH EXISTING FINISHES.
- REMOVE OLD WALL VINYL BEFORE INSTALLING NEW WALL VINYL OR PAINTING AN EXISTING WALL. PROVIDE A SKIM COAT OF GYPSUM PLASTER TO SMOOTH OUT WALL.
- ALL ITEMS WHICH ARE HUNG ON WALLS TO BE DEMOLISHED (BULLETIN BOARDS, ILLUMINATORS, FIRE EXTINGUISHERS, ETC) SHALL BE OFFERED TO THE HOSPITAL ENGINEERING DEPARTMENT. ITEMS NOT DESIRED BY THE OWNER SHALL BE REMOVED FROM THE SITE BY THE GENERAL CONTRACTOR.
- REPLACE DAMAGED CEILING TILE AND CEILING GRIDS WITH NEW TILE AND GRID TO MATCH EXISTING. PATCH AND REPAIR GYP. BD. CEILINGS AS REQUIRED FOR NEW WORK.

GRAPHIC SCALE: 1/32" = 1'-0"
GRAPHIC SCALE: 1/16" = 1'-0"
GRAPHIC SCALE: 3/32" = 1'-0"
GRAPHIC SCALE: 1/8" = 1'-0"
GRAPHIC SCALE: 3/16" = 1'-0"
GRAPHIC SCALE: 1/4" = 1'-0"
GRAPHIC SCALE: 3/8" = 1'-0"
GRAPHIC SCALE: 1/2" = 1'-0"
GRAPHIC SCALE: 3/4" = 1'-0"
GRAPHIC SCALE: 1" = 1'-0"
Autodesk Docs | 2024/03/01 - EOCMC IR Equipment Replacement | A2314
6/24/2024 3:30:35 PM